



PACKAGING

2015 PRODUCT CATALOG



Promotional Packaging - Corrugated Packaging - B2B Packaging - Boxes & Mailers
High Definition Printing - Digital Solutions - UV Finishing & More

GETTING STARTED

CONTENTS

1. Promotional Packaging
2. Boxes & Mailers
4. Specialty Packaging
5. Folding Cartons
6. Expander Products
7. Printing & Mailing Services
8. Non-Reinforced Folders
9. Reinforced & Box Pocket Folders
10. Stitched & Stepped Inserts
10. Mid-size & Mini Folders
11. Legal Folders
11. 3-Panel Folders
12. Key Card Holders
12. Slits
13. Report/Tax Covers
14. Tang Products & Page Inserts
14. Certificate Holders & Tabs
15. Laminated Paperboard Binders
15. Totes
16. Paperboard Mailers & Doc. Holders
17. Easel & Literature Holders
18. Slip Cases
18. CD/DVD Packaging
19. Custom Packaging
21. Finishing and more

ORDER INFORMATION

1. Select a product design from one of our many styles. Download Die-Line Templates at www.selectpkg.com
2. Select a stock. Most products can be produced on a variety of stocks. Choose one of our standard stocks or request pricing on special stocks.
3. Select a decoration process or combination of processes. Most products can be decorated using offset or digital printing. Check out page 21 for additional finishing options such as UV or foils.
4. Optional standard die cut slits are free of charge on all folders. Choose the business card, disk or literature slits of your choice. See page 12 for styles. Make sure to indicate the position on your purchase order.
5. Spine attachments can be stitched into the center of most folders. They are 14 pt. C1S white stock and come standard with (3) 3/4" fasteners and eyelets. Spine attachments require additional production time. Make sure to indicate if your order requires spine attachments on your purchase order.
6. Complete your order by calculating all applicable charges and issue a purchase order. Please fax or email your purchase order making sure to include all instructions and quote numbers. All orders require a written purchase order. We cannot accept verbal orders. All orders are subject to credit terms.
7. Send artwork. We accept electronic artwork only. It can be sent on a disk, via email or through our FTP site. Contact your sales rep for FTP credentials.

CORRUGATED GUIDELINES

One and two color prices are based on light ink coverage printing directly onto the box and have a white outside and Kraft inside. Artwork must be all line copy (no screens) and remain 1/4" away from scores and edges. Four color process is custom printed using high quality offset printing onto litho label that is then mounted to the corrugated board. Offset printing has no design restrictions.



PROMOTIONAL PACKAGING

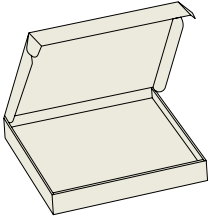

M-2000

6-1/2 x 4-1/2 x 1-1/4
Small Promotional Box with
1/2" tray. E-Flute Corrugate.
Ships flat.

**Prices include a custom die
cut tray fit to your product!**

*See corrugated guidelines on
inside front cover.*

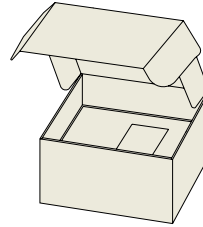

M-2004

8-1/2 x 5-1/2 x 4-1/2
Coffee Mug Mailer with tray.
E-Flute Corrugate.
Ships flat.

**Prices include a custom die
cut tray fit to your product!**

*See corrugated guidelines on
inside front cover.*

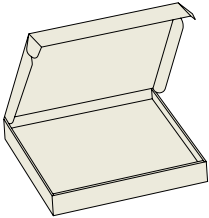

M-2001

9-1/2 x 6-1/4 x 2
Medium Promotional
Box with 1" tray.
E-Flute Corrugate.
Ships flat.

**Prices include a custom die
cut tray fit to your product!**

*See corrugated guidelines on
inside front cover.*

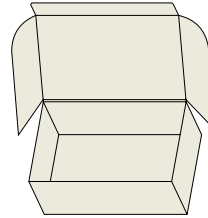

M-2005

10-3/4 x 7 x 4
Donut Box.
Ships flat.
14 Pt. C/1/S.

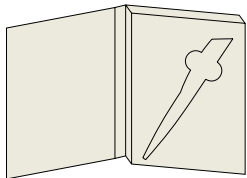

M-2002

4-1/4 x 5-1/2 x 1/2
2-Panel Pen Box
with Styrene Cavity.

Great
For USB
Drives!

**Prices include a custom die
cut tray fit to your product!**

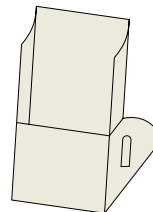

M-2007

4 x 7 x 1-1/2
Literature Holder.
E-Flute Corrugate.
Ships flat.

*See corrugated guidelines on
inside front cover.*

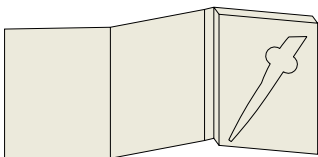

M-2003

4-1/4 x 5-1/2 x 1/2
3-Panel Pen Box
with Styrene Cavity.

**Prices include a custom die
cut tray fit to your product!**

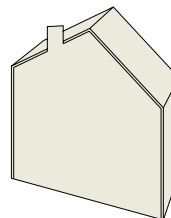

M-2008

7 x 6-3/8 x 1-5/8
House Box.
E-Flute Corrugate.
Ships flat.

*See corrugated guidelines on
inside front cover.*

BOXES & MAILERS

Boxes and Mailers assemble without tape or glue and ship flat. One and 2 color prices are based on light ink coverage printing directly on the box and has white outside and kraft inside. Artwork must be all line copy (no screens) and remain 1/4" away from scores and edges.

Four color process is custom printed using high quality offset printing onto litho label that is then mounted to the corrugated board. Four color jobs have a white inside and have no restrictions on placement of artwork.

Download Die-Line Templates at www.selectpkg.com

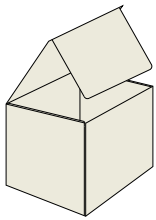

M-2010

4 x 4 x 4
Mug Box. All sides can be imprinted.
Copy must remain 1/4" away from scores on 1 and 2 color imprints.

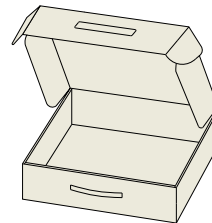

M-2012

12-1/8 x 9-1/4 x 3
Box with handle.
All sides can be imprinted.
Copy must remain 1/4" away from scores on 1 and 2 color imprints.

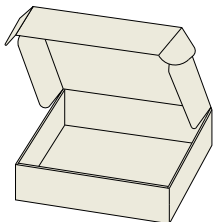

M-2011

9 x 6-1/2 x 2-3/4
Mailer. All sides can be imprinted.
Copy must remain 1/4" away from scores on 1 and 2 color imprints.

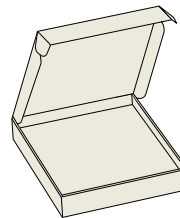

M-2013

12 x 12 x 2
Pizza Box. All sides can be imprinted.
Copy must remain 1/4" away from scores on 1 and 2 color imprints.

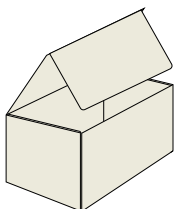

M-2014

5 x 3 x 3
Mailer. All sides can be imprinted.
Copy must remain 1/4" away from scores on 1 and 2 color imprints.

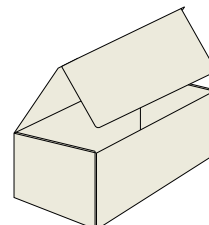

M-2015

8 x 4 x 3
Mailer. All sides can be imprinted.
Copy must remain 1/4" away from scores on 1 and 2 color imprints.

Film lamination is recommended on all corrugated projects, particularly those with heavy ink coverage in order to prevent cracking. In the event clients choose to proceed without lamination, the plant will not be held responsible for cracking that occurs on non-laminated jobs. Download Die-Line Templates at www.selectpkg.com

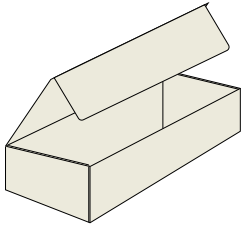

M-2016

12 x 3-1/2 x 3
Mailer. All sides can be imprinted.
Copy must remain 1/4" away from
scores on 1 and 2 color imprints.

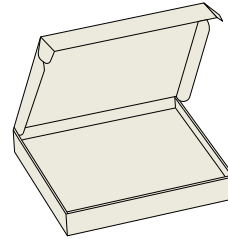

M-2019

11-1/8 x 8-3/4 x 3
Mailer. All sides can be imprinted.
Copy must remain 1/4" away from
scores on 1 and 2 color imprints.

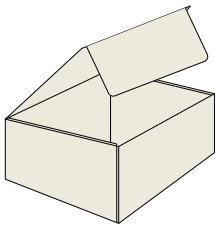

M-2017

6 x 2-1/2 x 2-3/8
Mailer. All sides can be imprinted.
Copy must remain 1/4" away from
scores on 1 and 2 color imprints.

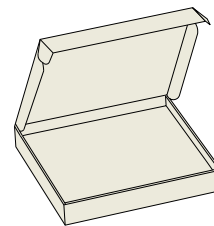

M-2020

12 x 11 x 3
Mailer. All sides can be imprinted.
Copy must remain 1/4" away from
scores on 1 and 2 color imprints.

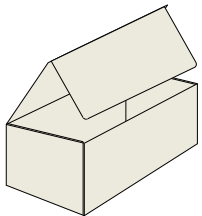

M-2018

7 x 5 x 4
Mailer. All sides can be imprinted.
Copy must remain 1/4" away from
scores on 1 and 2 color imprints.

CUSTOM BOXES

We specialize in custom boxes. Our design and product development group will work with you every step of the way, helping you select the products that best meet your creative and budget objectives. We can provide prototypes made to your specifications, enabling you to plan each project with greater precision.

See More Custom Packaging on Page 19.



SPECIALTY PACKAGING

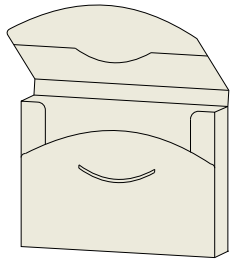

M-2022
9 x 12 x 1/2
E-Flute Tote

M-2023
9 x 12 x 1
E-Flute Tote
Ships flat

One and 2 color prices are based on all line copy and light to medium ink coverage printing directly on the box and has white outside and kraft inside. Four color process is custom printed using high quality offset printing onto litho label then mounted to the corrugated board and has no restrictions on placement of artwork.

Download Die-Line Templates at www.selectpkg.com

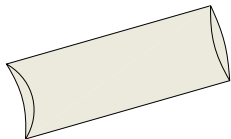

M-2040
6 x 4-1/2 x 1-1/2
Pillow Pack. Both sides can be imprinted. 1 and 2 color prices based on light to medium ink coverage. 14 Pt. C/1/S.

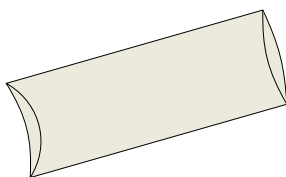

M-2041
10 x 5 x 2
Pillow Pack. 1 and 2 color prices based on light to medium ink coverage. 14 Pt. C/1/S.

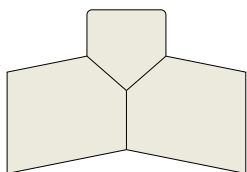

M-2042
4-1/4 x 5-1/2
Pop-Up Mailer. Add your message or gift card to pop up area. Both sides can be printed. Ships flat. 100# Gloss Cover.

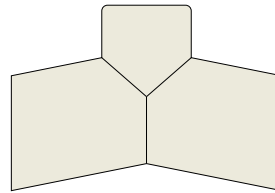

M-2043
5 x 7
Custom Pop-Up Mailer. Customize the shape of the pop-up area. Prices include custom die cutting die. Both sides can be printed. Ships flat. 100# Gloss Cover.

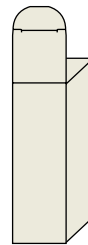

M-2044
3-Pack Golf Ball Sleeve.
Ships flat. 14 Pt. C/1/S.

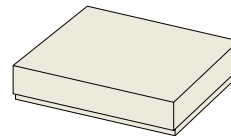

M-2045
Dozen Golf Ball Box
Ships flat. 18 Pt. C/1/S.

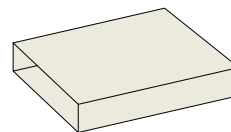

M-2046
Dozen Golf Ball Sleeve
Ships flat. 14 Pt. C/1/S.

FOLDING CARTONS

We design and manufacture folding cartons in many styles and sizes. Our design team will help you choose the correct substrate, size and configuration to hold your product.

Commonly used styles include: straight and reverse tuck closures, auto bottom and two piece cartons. Consult your sales representative for samples and prototypes. Download Die-Line Templates at www.selectpkg.com

MEASURE A FOLDING CARTON BY THE DIMENSIONS: L X W X D

L-Length: The dimension across the box opening from left to right if box is facing you and the top facing up.

W-Width: The dimension from the front panel to the back panel.

D-Depth: The dimension from the top (opening side) to the bottom (opening side) showing how deep the carton is.

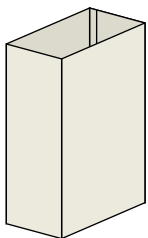
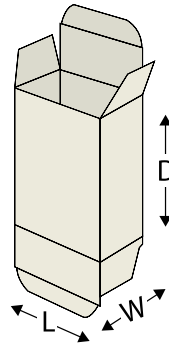

Sleeve

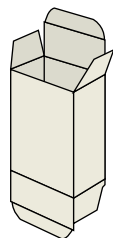

Reverse Tuck

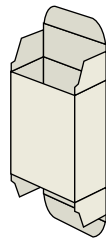

Straight Tuck

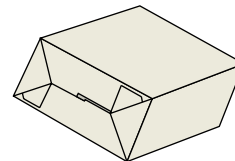

Auto Bottom

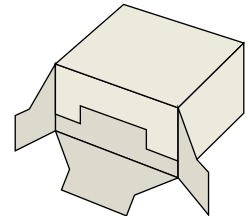

1-2-3 Bottom

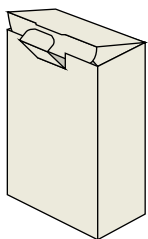

Tuck & Tongue

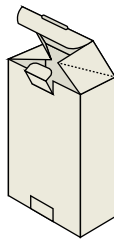

Bellows (Gusset) Tuck

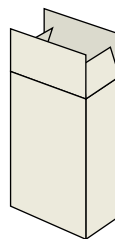

Full Overlap Seal End

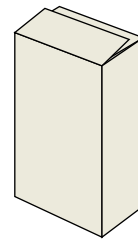

Partial Overlap Seal

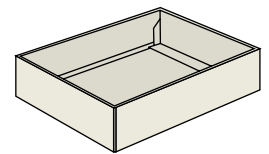

Simplex Tray



EXPANDER PRODUCTS

Our time tested Expander Products work hard to provide increased flexibility to those projects that require additional capacity. These products are proven to be extremely versatile and add increased value to your project.

The functionality of our Expander products allow for expansion while maintaining a clean and neat appearance. Our folders can easily hold up to 100 sheets of paper. Match a folder with one of our mailers for a complete presentation package. There are no additional costs for Expander products. Samples and custom sizes are available. Download Die-Line Templates at www.selectpkg.com

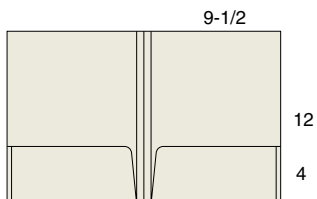

X-900

9-1/2 x 12
Expandable Folder with (2) 4" glued pockets (Same price as M-100, see page 8).

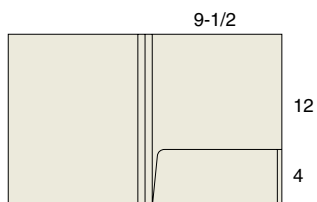

X-903

9-1/2 x 12
Expandable Folder with (1) 4" right glued pocket (Same price as M-100, see page 8).

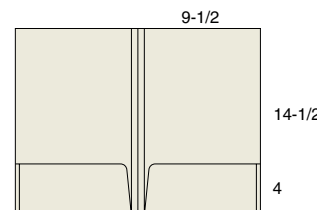

X-905

9-1/2 x 14-1/2
Expandable Legal folder with (2) 4" glued pockets (Same price as M-116, see page 14).

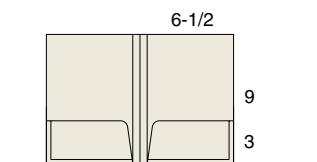

X-909

6-1/2 x 9
Expandable Mid-size folder with (2) 3" glued pockets (Same price as M-119, see page 13).

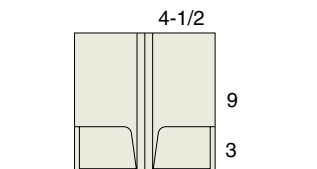

X-910

4-1/2 x 9
Expandable Mini folder with (2) 3" glued pockets (Same price as M-121, see page 13).

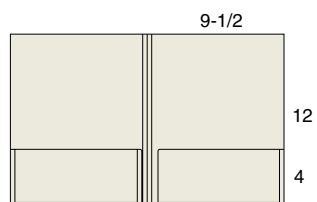

X-915

9-1/2 x 12
Expandable Folder with (1) 4" left glued pocket and (1) 4" right pocket glued both sides.

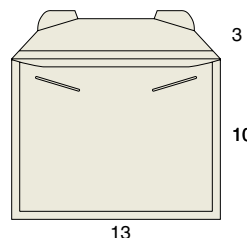

X-901

10 x 13
Expandable Mailer with 3" flap and tuck closure (5/8" Capacity).

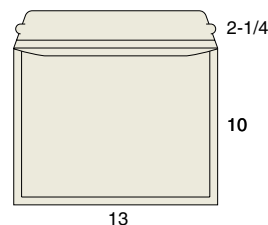

X-902

10 x 13
Expandable Mailer with 2-1/4" flap with nylon tear strip (5/8" Capacity).

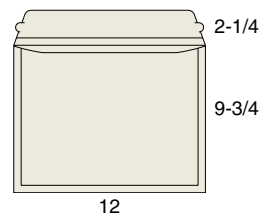

X-916

9-3/4 x 12
Expandable Mailer with 2-1/4" flap with nylon tear strip (5/8" Capacity).

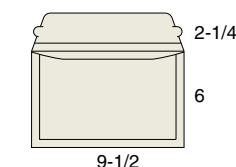

X-917

9-1/2 x 6
Expandable Mailer with 2-1/4" flap with nylon tear strip (1/2" Capacity).

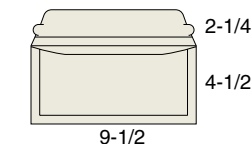

X-918

4-1/2 x 9-1/2
Expandable Mailer with 2-1/4" flap with nylon tear strip (3/8" Capacity).

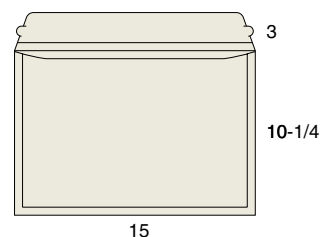

X-919

10-1/4 x 15
Expandable Mailer with 3" flap with nylon tear strip (5/8" Capacity).



PRINTING

The printing process is equal parts manufacturing, art and science. Achieve unsurpassed image detail and electrifying color with industry leading Co-Res screening technology.

- ✓ UV Offset Printing
- ✓ HP Indigo Digital Printing
- ✓ Personalization/VDP
- ✓ Prepress Services
- ✓ Web-to-Print
- ✓ Packaging
- ✓ Kitting & Fulfillment
- ✓ Bindery & Finishing
- ✓ Full Service Mailing



MAILING

Can we deliver? 1,000,000 pieces mailed monthly says so. Combine the right message with the right mail mode for stronger impressions, higher response rates and bigger yields.

- ✓ Direct Mail
- ✓ Fundraising Campaigns
- ✓ Data List Processing
- ✓ Data List Sourcing
- ✓ Automated Insertion
- ✓ Personalization
- ✓ Money Saving Co-Services
- ✓ Corrugated Mailers



NON-REINFORCED FOLDERS

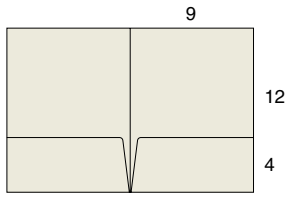

M-100

9 x 12
Folder with (2) 4" glued pockets.

M-101

9 x 12
Folder with (2) 3" glued pockets (not pictured).

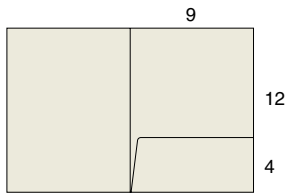

M-102

9 x 12
Folder with (1) 4" right glued pocket.

M-103

9 x 12
Folder with (1) 3" right glued pocket (not pictured).

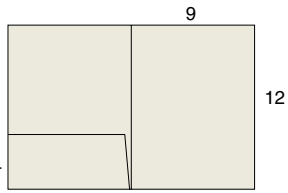

M-104

9 x 12
Folder with (1) 4" left glued pocket.

M-105

9 x 12
Folder with (1) 3" left glued pocket (not pictured).

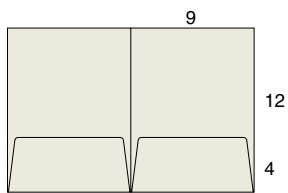

M-106

9 x 12
Folder with (2) 4" unglued flaps.

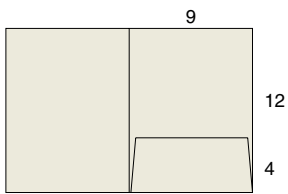

M-107

9 x 12
Folder with (1) 4" unglued right flap.

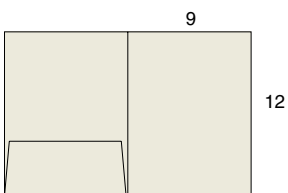

M-108

9 x 12
Folder with (1) 4" unglued left flap.

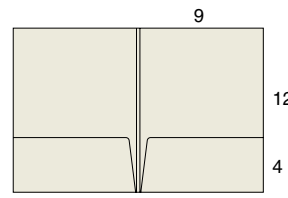

M-109

9 x 12
Folder with (2) 4" glued pockets and 1/4" spine.

M-110

9 x 12
Folder with (2) 4" glued pockets and 1/2" spine (not pictured)

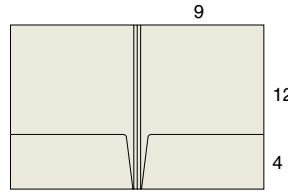

M-111

9 x 12
Folder with (2) 4" glued pockets and triple score spine.

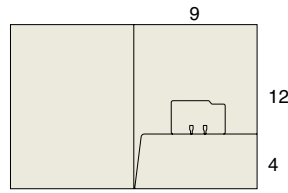

M-112

9 x 12
Folder with (1) 4" glued pocket and file card.

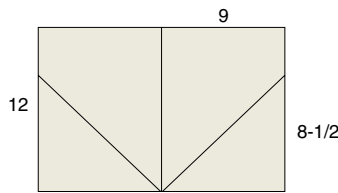

M-113

9 x 12
Folder with (2) 8-1/2" glued angled pockets.

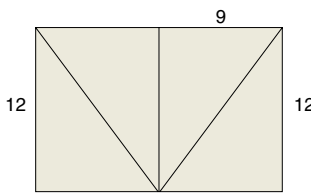

M-114

9 x 12
Folder with (2) 12" glued angled pockets.

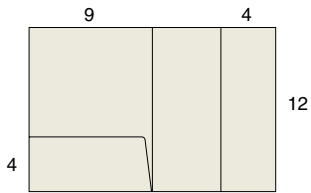

M-115

9 x 12
Folder with (1) 4" horizontal pocket and (1) 4" vertical pocket.

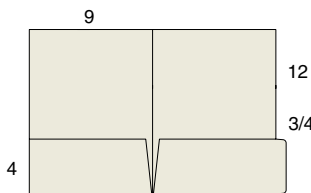

M-129

9 x 12
Folder with (2) 4" glued pockets and (1) 3/4" file tab extension.

REINFORCED FOLDERS & BOX POCKET FOLDERS

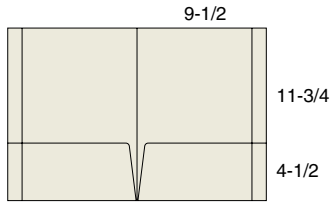

M-200
9-1/2 x 11-3/4
Folder with (2) 4-1/2"
glued pockets.

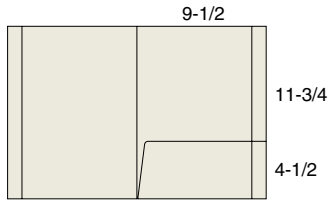

M-201
9-1/2 x 11-3/4
Folder with (1) 4-1/2"
right glued pocket.

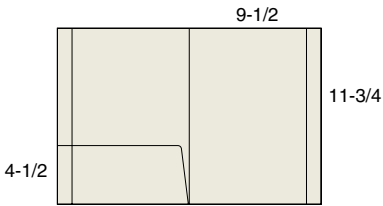

M-202
9-1/2 x 11-3/4
Folder with (1) 4-1/2"
left glued pocket.

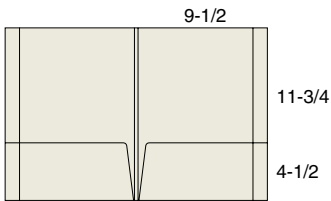

M-203
9-1/2 x 11-3/4
Folder with (2) 4-1/2" glued
pockets and 1/4" spine.

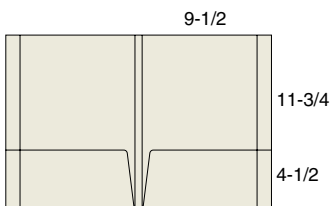

M-204
9-1/2 x 11-3/4
Folder with (2) 4-1/2" glued
pockets and 1/2" spine.

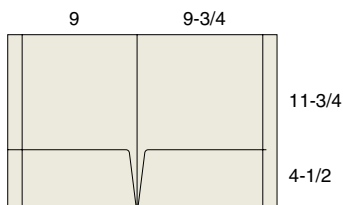

M-205
9-3/4 x 11-3/4
Folder with (2) 4-1/2" glued
pockets and extended tab.

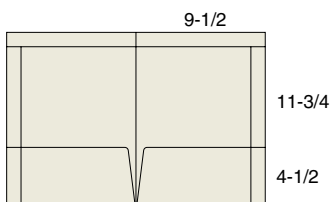

M-206
9-1/2 x 11-3/4
Folder with (2) 4-1/2" glued
pockets and reinforced top.

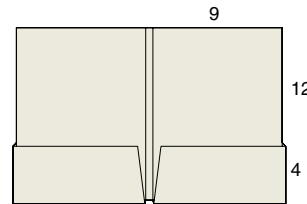

M-300
9 x 12
Folder with (2) 4" x 1/4"
box pockets and 9/16" spine.

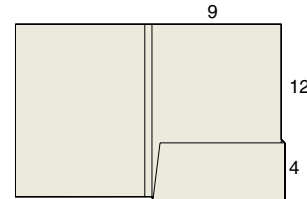

M-301
9 x 12
Folder with (1) 4" x 1/4" right
box pocket and 5/16" spine.

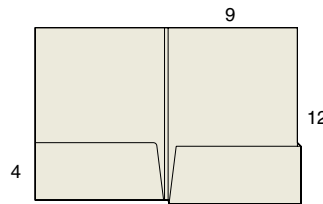

M-302
9 x 12
Folder with (1) 4" left flat
glued pocket and (1) 4" x 1/4"
right box pocket and 5/16" spine.

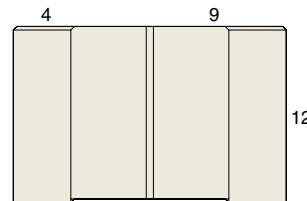

M-303
9 x 12
Folder with (2) vertical 4" x 1/4"
box pockets and 9/16" spine.

M-304
Available with 5/16" spine
(not pictured).

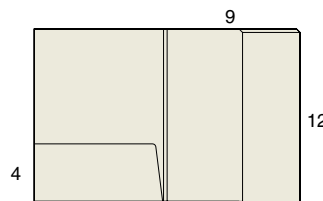

M-305
9 x 12
Folder with (1) 4" left flat
glued pocket and (1) 4" x 1/4"
right vertical box pocket
and 5/16" spine.

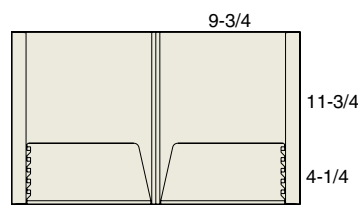

M-306
9-3/4 x 11-3/4
Folder with (2) 4-1/4" x 1/4"
expandable zipper pockets
and 9/16" triple score spine
(Same pricing as M-200).

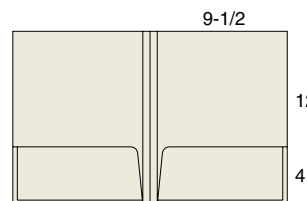

M-307
9.5 x 12
Expandable Folder with
(2) 4" glued pockets

STITCHED & STEPPED INSERTS

Stitched Inserts

4, 8, 12, And 16 Page Stitched Inserts Available. Stitched Inserts are available with styles M-100 through M-108 only.

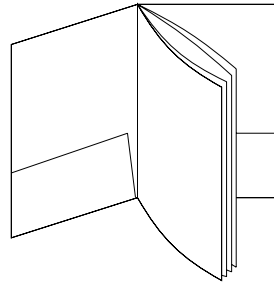

Stepped Inserts

Stepped Inserts are available to fit all size folders and can be produced on the stock of your choice. Inserts can be printed one or two sides and special die cutting and film lamination is also available. Please call for pricing.

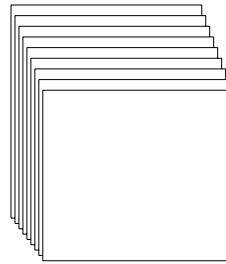

MID-SIZE & MINI FOLDERS

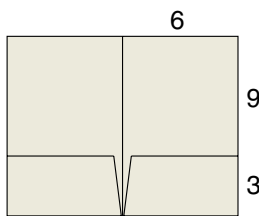

M-119

6 x 9
Mid-size Folder with
(2) 3" glued pockets.

M-120

6 x 9
Mid-size Folder with (1) 3" right
glued pocket (not pictured).

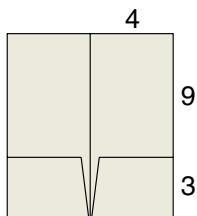

M-121

4 x 9
Mini Folder with (2) 3"
glued pockets.

M-122

4 x 9
Mini Folder with (1) 3" right
glued pocket (not pictured).



EXPANDER

*Need a little extra capacity?
Try one of our Expander Folders
at no additional cost!
See page 6 for details.*

LEGAL FOLDERS

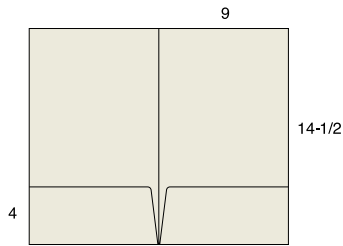

M-116
9 x 14-1/2
Legal Size Folder with
(2) 4" glued pockets.

M-117
9 x 14-1/2
Legal Size Folder with
(2) 3" glued pockets
(not pictured).

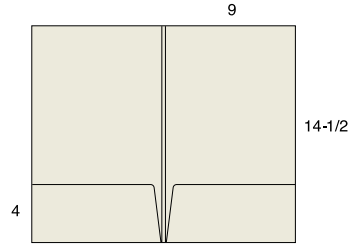

M-118
9 x 14-1/2
Legal Size Folder with
(2) 4" glued pockets
and 1/4" spine.

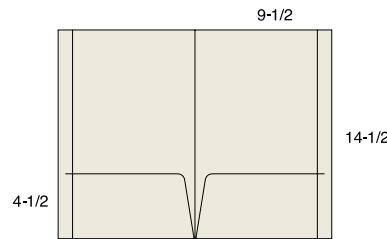

M-207
9-1/2 x 14-1/2
Folder with (2) 4-1/2"
glued pockets.

3-PANEL FOLDERS

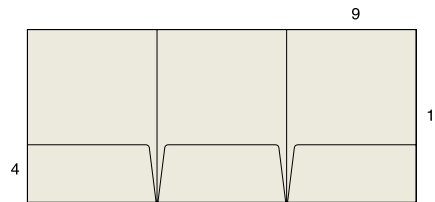

M-400
9 x 12
Folder with (2) 4" outside
glued pockets and (1)
4" center unglued flap.

M-401 9 x 12
Folder with (1) 4"
center unglued flap.

M-404 9 x 12
Folder with (1) 4"
left glued pocket.

M-402 9 x 12
Folder with (2) 4"
outside glued pockets.

M-405 9 x 12
Folder with (1) 4"
center unglued flap
and (1) 4" right
glued pocket.

M-403 9 x 12
Folder with (1) 4"
right glued pocket.

M-406 9 x 12
Folder with (1) 4"
left glued pocket
and (1) 4" center
unglued flap.

KEY CARD HOLDERS

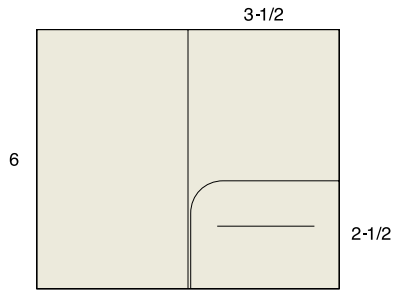

M-1100

3-1/2 x 6
Folder with (1)
2-1/2" pocket.

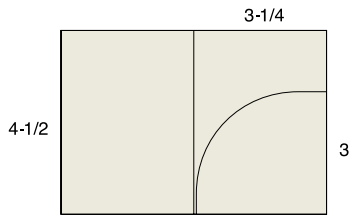

M-1101

3-1/4 x 4-1/2
Folder with (1)
3" pocket.

SLITS

BUSINESS CARD SLITS

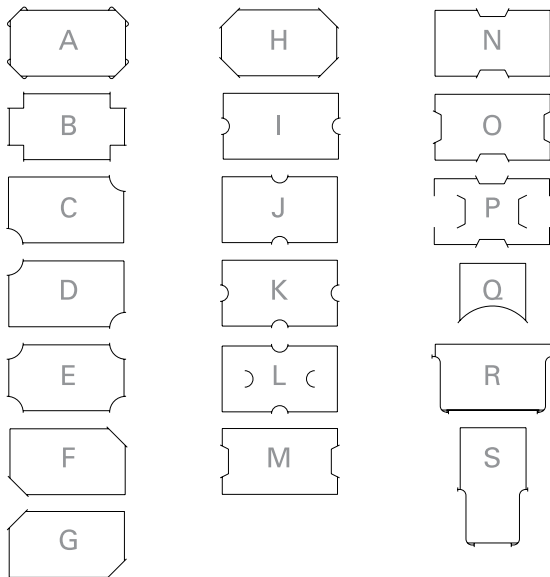

DISK & BROCHURE SLITS

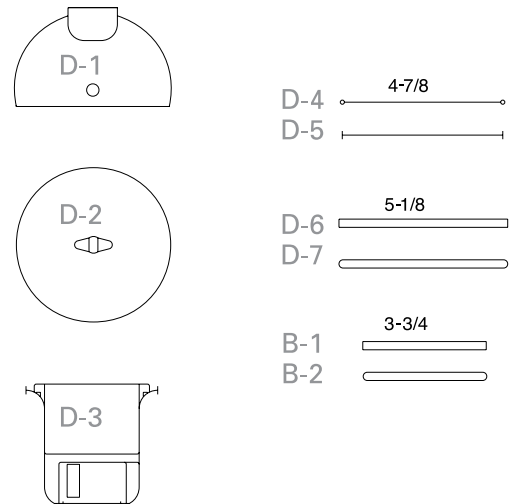

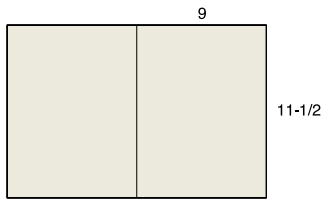

M-500
9 x 11-1/2
One piece report cover.

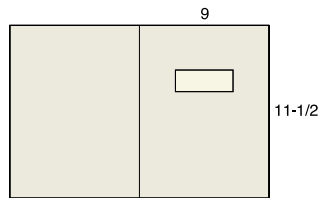

M-501
9 x 11-1/2
One piece report cover with window.

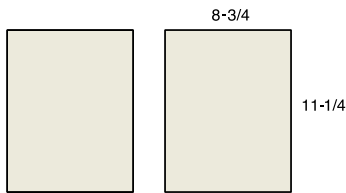

M-502
8-3/4 x 11-1/4
Two piece report cover.

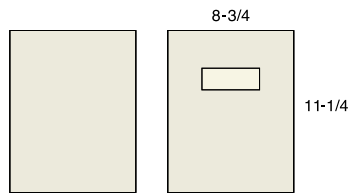

M-503
8-3/4 x 11-1/4
Two piece report cover with window.

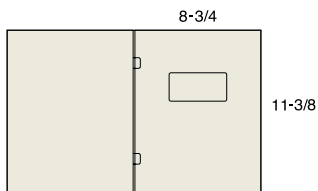

M-504
8-3/4 x 11-3/8
One piece – side stitch report cover with window.

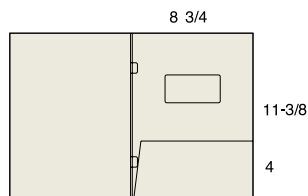

M-505
8-3/4 x 11-3/8
One piece – side stitch report cover with (1) 4" glued pocket and window.

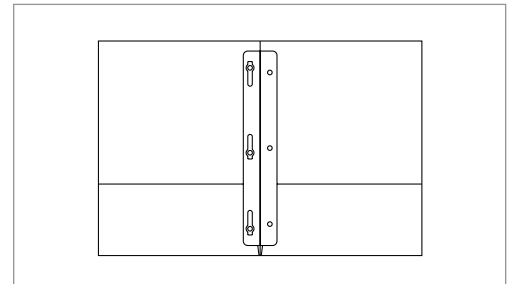

Spine attachments can be stitched into the center of M-500 and M-501. They are 14 pt. C1S white stock and come standard with (3) 3/4" fasteners and eyelets. Spine attachments require additional production time. Make sure to indicate if your order requires spine attachments on your purchase order.



**Round
Corners**

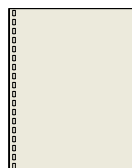

**Comb
Binding
Punch**

TANG PRODUCTS

PAGE POCKETS

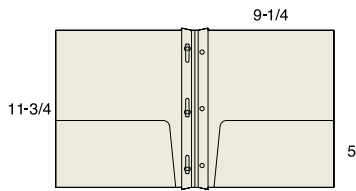

M-800
Tang Folder
with (2) 5"
glued pockets

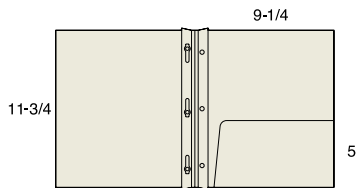

M-801
Tang Folder
with (1) 5"
glued pocket

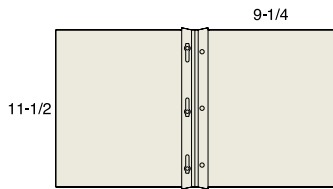

M-802
Tang Cover
without pockets

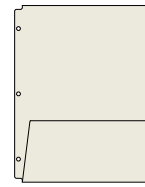

M-1300
9 x 11-1/2
Page Pocket
12 Pt. C/1/S.

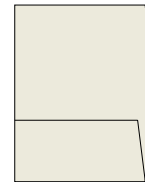

M-1301
9 x 11-1/2
Page Pocket
12 Pt. C/1/S.

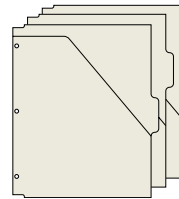

M-1302
9 x 11-1/2
3 Tabbed
Page Pockets

CERTIFICATE HOLDERS

TABS

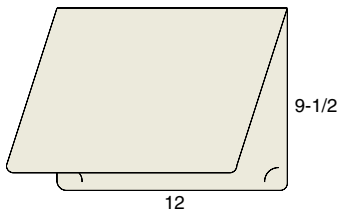

M-1250
9-1/2 x 12
Certificate Holder.
Holds 8-1/2" x 11" sheet.

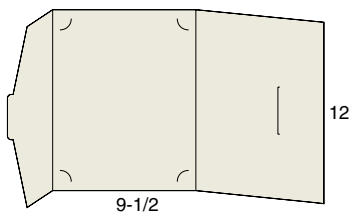

M-1251
9-1/2 x 12
Certificate Holder.
Wrap around cover with
self-forming easel.

Don't forget Tabs! We make them in a variety of materials and colors. Stock and custom sizes are available with or without mylar reinforcing. Please call for pricing.

Download Die-Line Templates at www.selectpkg.com



LAMINATED PAPERBOARD BINDERS

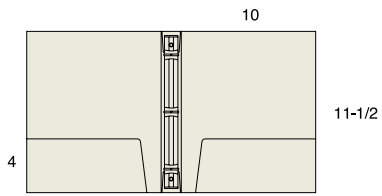

M-700

Binder with (2)
4" glued pockets
(1/2" ring size shown).

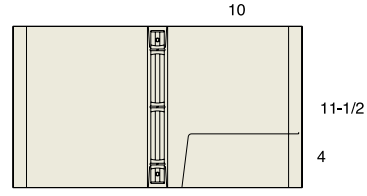

M-703

Binder with (1)
4" glued pocket and
reinforced edges
(1/2" ring size shown).

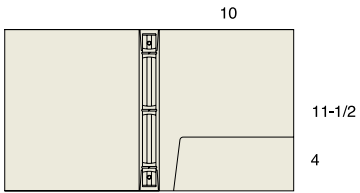

M-701

Binder with (1)
4" glued pocket
(1/2" ring size shown).

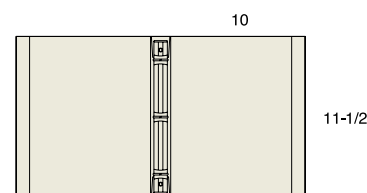

M-704

Binder without pockets
with reinforced edges
(1/2" ring size shown).

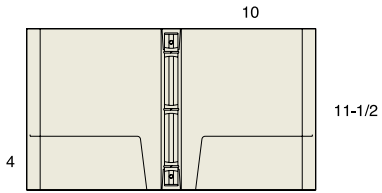

M-702

Binder with (2)
4" glued pockets and
reinforced edges
(1/2" ring size shown).

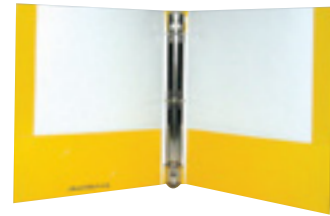

TOTES

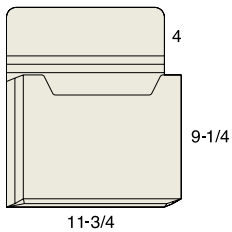

M-1001

9-1/4 x 11-3/4
Expandable Tote with 4" flap.
Available in 1-1/4", 1-1/2", or
2" capacity. 14 Pt. C/1/S.

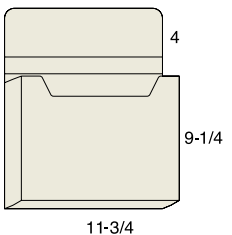

M-1003

9-1/4 x 11-3/4
Fixed Capacity Tote with 4" flap.
18 Pt. C/1/S.

Totes are available in 5/8", 1", 1-1/2" or 2"
capacity and come standard with 1 set of
Velcro dots. Totes ship fully assembled.

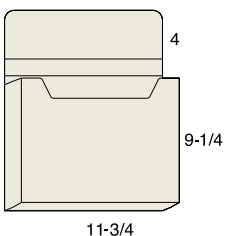

M-1005

9-1/4 x 11-3/4
Fixed Capacity Locking Tote with 4" flap.
Ships flat. 18Pt. C/1/S.

Totes are available in 1" capacity and come
standard with 1 set of Velcro dots.

PAPERBOARD MAILERS & DOCUMENT FOLDERS

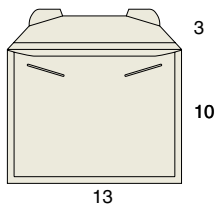

X-901

10 x 13
Expandable Mailer with
3" flap and tuck closure
(5/8" Capacity).

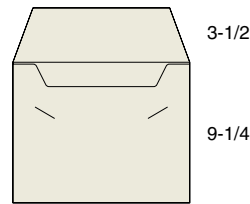

M-1000

9-1/4 x 11-3/4
Flat Mailer with 3-1/2" flap.
14 Pt. C/1/S.

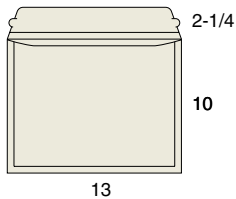

X-902

10 x 13
Expandable Mailer
with 2-1/4" flap and nylon
tear strip (5/8" Capacity).

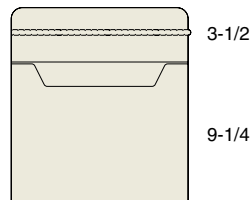

M-1002

9-1/4 x 11-3/4
Flat Mailer with 3-1/2" flap
and nylon tear strip.
14 Pt. C/1/S.

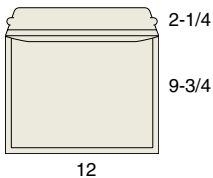

X-916

9-3/4 x 12
Expandable Mailer
with 2-1/4" flap and nylon
tear strip (5/8" Capacity).

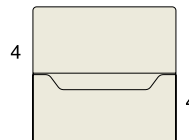

M-1004

4 x 9
Document Folder with
4" flap. 12 Pt. C/1/S.

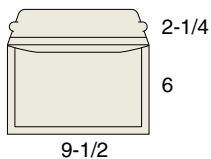

X-917

6 x 9-1/2
Expandable Mailer
with 2-1/4" flap and nylon
tear strip (1/2" Capacity).

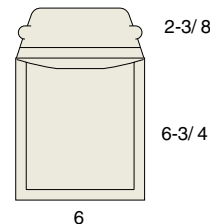

X-930

6 x 6-3/4
Expandable CD/DVD
Mailer with 2-3/8" flap
and nylon tear strip.

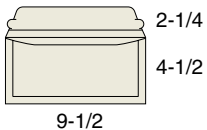

X-918

4-1/2 x 9-1/2
Expandable Mailer
with 2-1/4" flap and nylon
tear strip (3/8" Capacity).

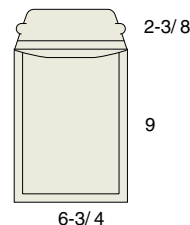

X-931

6-3/4 x 9
Expandable CD/DVD
Mailer with 2-3/8" flap
and nylon tear strip.

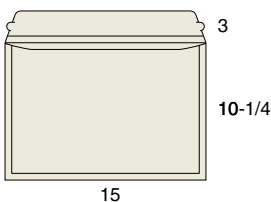

X-919

10-1/4 x 15
Expandable Mailer
with 3" flap and
nylon tear strip
(5/8" Capacity).

EASEL & LITERATURE HOLDERS

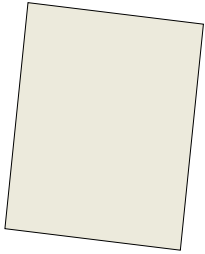

M-2070

8 x 10
Pop-Up Easel.
Ships flat.
18 Pt. C/1/S with
Film Lamination.

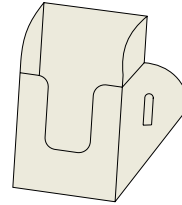

M-2074

2-3/4 x 3-1/2 x 1-1/2
Pocket schedule holder.
Ships flat.
18 Pt. C/1/S.

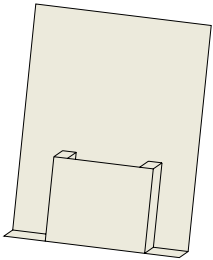

M-2071

8 x 10
Pop-Up Easel with
built in 3-3/4 x 4-1/4"
push up pocket.
Ships flat.
18 Pt. C/1/S with
Film Lamination.

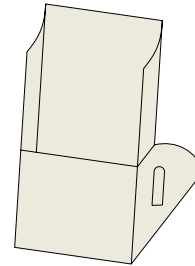

M-2075

4 x 7 x 1-1/2
Literature holder.
Ships flat.
18 Pt. C/1/S.

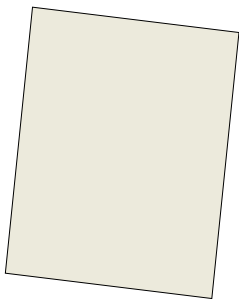

M-2072

9 x 12
Pop-Up Easel.
Ships flat.
18 Pt. C/1/S with
Film Lamination.

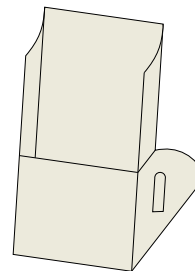

M-2007

4 x 7 x 1-1/2
Literature holder.
Ships flat.
E-Flute Corrugated board.

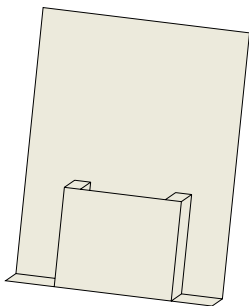

M-2073

9 x 12
Pop-Up Easel with
built in 3-3/4 x 4-1/4"
push up pocket.
Ships flat.
18 Pt C/1/S with
Film Lamination.

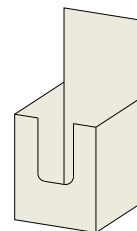

M-2076

2-3/4 x 3-1/2 x 5
Pocket schedule
display box. Top flap
forms a header panel
when open. Ships flat.
14 Pt. C/1/S.

SLIP CASES

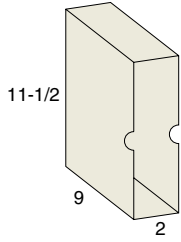

M-2080

2" Slip Case with lock tab construction. 24 Pt. C/1/S with Gloss film lamination. Ships flat.

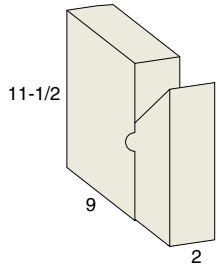

M-2081

2" Slip Case / Slant Case Set with lock tab construction. 24 Pt. C/1/S with Gloss film lamination. Ships flat.

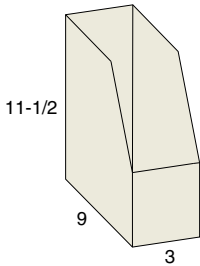

M-2083

3" Corrugated Slant Case with lock tab construction. E-Flute corrugated board. Ships flat on skids.

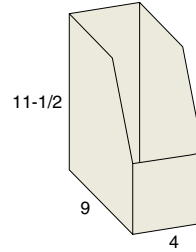

M-2084

4" Corrugated Slant Case with lock tab construction. E-Flute corrugated board. Ships flat on skids.

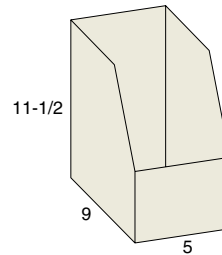

M-2085

5" Corrugated Slant Case with lock tab construction. E-Flute corrugated board. Ships flat on skids.

Film lamination is recommended on all corrugated projects, particularly those with heavy ink coverage in order to prevent cracking. In the event clients choose to proceed without lamination, the plant will not be held responsible for cracking that occurs on non-laminated jobs.

Download Die-Line Templates at www.selectpkg.com

CD/DVD PACKAGING

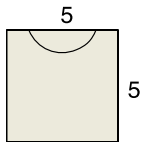

M-600

5 x 5 Single CD Sleeve.

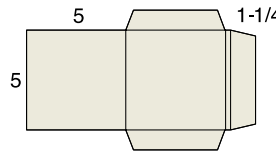

M-605

5 x 5 Economy CD Mailer #1.

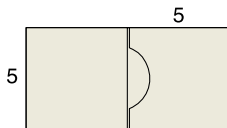

M-601

5 x 5 Single CD Sleeve with flap.

M-606

5 x 5 Economy CD Mailer with #2 Tuck closure.

M-602
5 x 5 Single CD Sleeve with reinforced panel.

M-603
5 x 5 Double CD Sleeve.

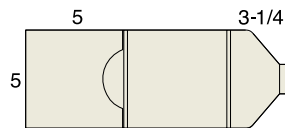

M-607

5 x 5 Single CD Mailer with reinforced panel with Tuck closure

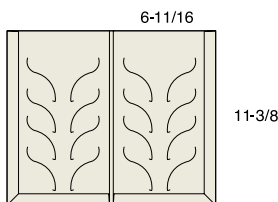

M-604

6-11/16 x 11-3/8 CD Library (holds 4, 6 or 8 CD's)

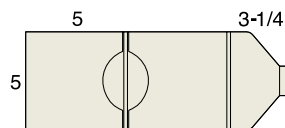

M-608

5 x 5 Double CD Mailer Tuck closure.

We design and manufacture a broad range of products that can bring a unique and lasting impact to your communication programs. Our complete line of custom packaging can add excitement, organization and performance. Our ability to custom design products to meet your most specified needs provides you with an unlimited variety of creative solutions.

Our design and product development group will work with you every step of the way, helping you select the products that best meet your customer's creative and budget objectives. We can provide prototypes made to your specifications, enabling you to plan each project with greater precision. Because we utilize a CAD system we can provide prototypes, enabling you to plan each project.

As a leading innovator in the art of packaging, we are committed to uncompromising excellence in every product we make. With all of our manufacturing resources in house, we maintain the highest standards of quality control, delivering every product with single-source reliability and convenience.



Custom Promotional Packaging



CUSTOM PACKAGING

Custom Display Packaging



Custom Totes



Custom Folders

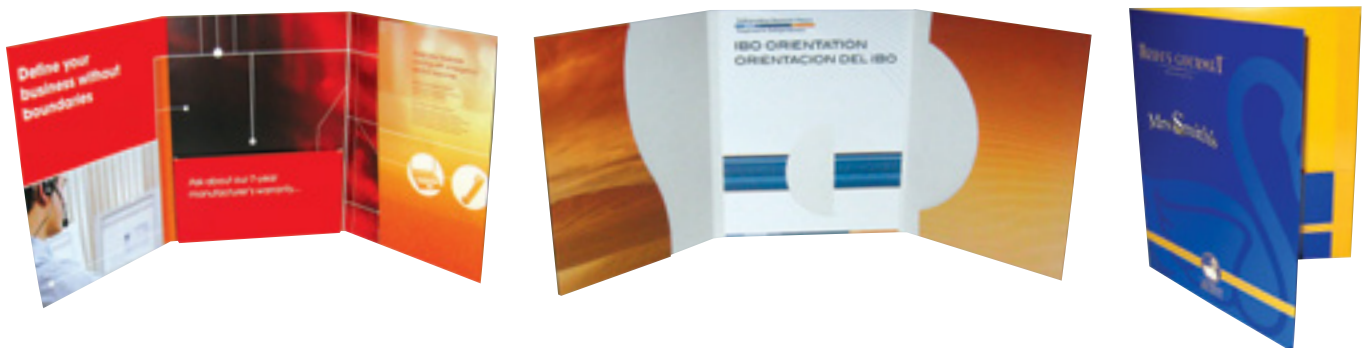









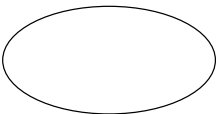
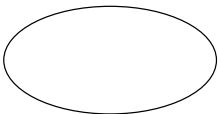
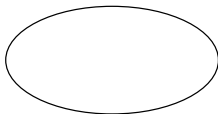
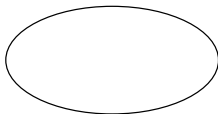
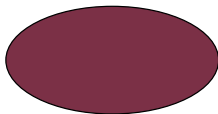

Foil Stamping, Embossing, Spot UV, Soft Touch Aqueous, Die Cutting... A lost art? Not at all! We combine the craftsmanship and knowledge of our artisans with today's technology to produce some of the most stunning foil and embossing effects. Need help or suggestions on ways to dress up your next project? We're here to help you.

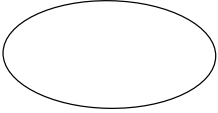
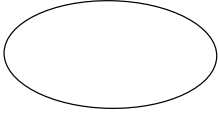
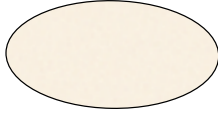
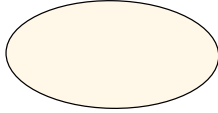
When your project calls for a custom die cut, we can help there too. Our engineering department can provide you with prototypes and electronic templates. See a list of our most popular finishing options below:

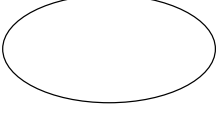
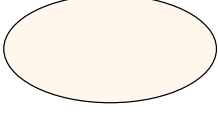
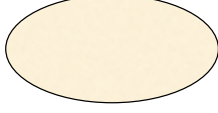
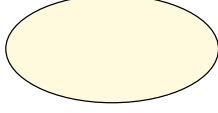
- Foil Stamping
- Embossing/Debossing
- Custom Die-Cutting
- Spot/Overall UV Coating
- Gloss Varnish
- Dull Varnish
- Strike-Through
- Soft-Touch
- Aqueous Coating
- Gloss Lamination
- Matte Lamination
- PMS Colors

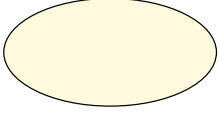
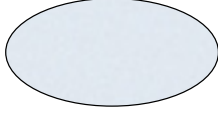

Color Selection Guide

Economy Papers	Base Papers		Base Plus Papers	Premium Papers	Premium Plus Papers
 12Pt. C/1/S White Semi Gloss	 12Pt. C/2/S White Semi Gloss	 80# White Royal Fiber Cover	 80# Cool White Felt Cover	 80# Burgundy Linen Cover	 80# Forest Green Felt Cover
 100# White Gloss Cover (10Pt.)	 80# Bright White Linen Cover	 80# Natural Royal Fiber Cover	 80# Cream White Felt Cover	 80# Emerald Linen Cover	 80# Deep Blue Felt Cover
 80# White Smooth Cover	 80# Natural Linen Cover	 80# Cream Royal Fiber Cover	 80# Ivory Felt Cover	 80# Midnight Blue Linen Cover	Black Felt  80# Black Felt Cover
	 80# Ivory Linen Cover	 80# Ice Blue Royal Fiber Cover	 80# Light Gray Felt Cover	 80# Black Linen Cover	
	 80# Gray Linen Cover	 80# Gray Royal Fiber Cover			

Swatches shown are printed representations of our stocks. Actual colors, textures and availability subject to change. Paper samples available by request.



ENVISION3

630.825.1200 | WWW.ENVISION-3.COM

